

ASSEMBLY ACCESSORIES

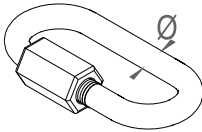

TWISTED LINK



OGS ...					
Cat. No.	Symbol		Um	Weight [kg/pc.]	φ[mm]
786300	OGS 4	200	pcs.	0,010	4
786301	OGS 5	100	pcs.	0,020	5
786302	OGS 6	100	pcs.	0,030	6

Application:
Connecting chains.

Material:
Galvanized steel (DIN 50961)

DRESSED LINK

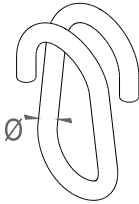

OGK ...					
Cat. No.	Symbol		Um	Weight [kg/pc.]	φ[mm]
790567	OGK 4	200	pcs.	0,010	4
790568	OGK 5	100	pcs.	0,020	5
790569	OGK 6	100	pcs.	0,030	6

Application:
Connecting chains.

Material:
Galvanized steel (DIN 50961)

THIMBLE



KSZ ...					
Cat. No.	Symbol		Um	Weight [kg/pc.]	
786307	KSZ3	100	pcs.	0,003	
786308	KSZ4	100	pcs.	0,005	
786309	KSZ5	100	pcs.	0,006	

Application:
Protecting cords against seizure.

Material:
Galvanized steel (DIN 50961)

HOOK

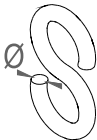

HCZ ...					
Cat. No.	Symbol		Um	Weight [kg/pc.]	φ[mm]
786310	HCZ 3	100	pcs.	0,005	3
786311	HCZ 4	100	pcs.	0,010	4
786312	HCZ 5	100	pcs.	0,015	5
786313	HCZ 6	100	pcs.	0,025	6

Application:
Connecting chains.

Material:
Galvanized steel (DIN 50961)

BOLT-MUSHROOM HEAD, NUT, WASHER (SET)

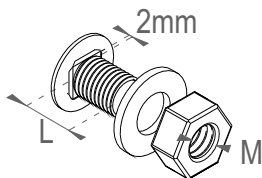

Application:
Connecting cable trays.

Material:
Galvanized steel (DIN 50961)

SGNP ...

Cat. No.	Symbol		Um	Weight [kg/pc.]	Dim. L [mm]	Dim. M [mm]
786317	SGNP M6x10	100	pcs.	0,007	10	6
790815	SGNP M6x12	100	pcs.	0,007	12	6
786318	SGNP M6x25	100	pcs.	0,010	25	6
786319	SGNP M8x12	100	pcs.	0,017	12	8
786320	SGNP M8x14	100	pcs.	0,018	14	8
786321	SGNP M12x30	100	pcs.	0,088	30	12

BOLT-MUSHROOM HEAD, NUT, TOOTH WASHER (SET)

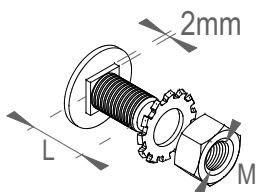

Application:
Connecting cable trays.

Material:
Galvanized steel (DIN 50961).

SGNPZ ...

Cat. No.	Symbol		Um	Weight [kg/pc.]	Dim. L [mm]	Dim. M [mm]
790572	SGNPZ M6x10	100	pcs.	0,007	10	6
790573	SGNPZ M6x25	100	pcs.	0,010	25	6
790574	SGNPZ M8x12	100	pcs.	0,017	12	8
790575	SGNPZ M8x14	100	pcs.	0,018	14	8
790576	SGNPZ M12x30	100	pcs.	0,088	30	12

BOLT-MUSHROOM HEAD, FLANGE NUT (SET)

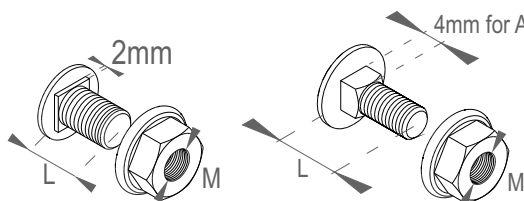

Application:
Connecting cable trays..

Material:
Galvanized steel (DIN 50961).

SGNKK ...

Cat. No.	Symbol		Um	Weight [kg/pc.]	Dim. L [mm]	Dim. M [mm]
789676	SGNKK M6x10	100	pcs.	0,008	10	6
791795	SGNKK M6x12	100	pcs.	0,008	12	6
789677	SGNKK M6x25	100	pcs.	0,010	25	6
789678	SGNKK M8x12	100	pcs.	0,017	12	8
789679	SGNKK M8x14	100	pcs.	0,017	14	8

Material:
Stainless steel A2.
On request: stainless steel A4.

SGNKK A2 ...

Cat. No.	Symbol		Um	Weight [kg/pc.]	Dim. L [mm]	Dim. M [mm]
791579	SGNKK A2 M6x12	100	pcs.	0,008	12	6
791580	SGNKK A2 M8x16	100	pcs.	0,023	16	8



VII

DROP-IN ANCHOR

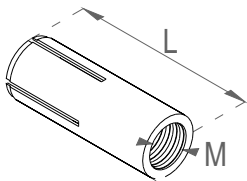

Application:
Fixing cable routes elements.

Material:
TRM - Brass
TRS - Galvanized steel (DIN 50961)
On request: stainless steel (A2 or A4)

TRM ...

Cat. No.	Symbol	Um	Weight [kg/pc.]	Dim. L [mm]	Dim. M [mm]
786323	TRM M6	100 pcs.	0,004	24	6
786325	TRM M8	100 pcs.	0,007	30	8
786327	TRM M10	50 pcs.	0,011	34	10
786329	TRM M12	50 pcs.	0,024	40	12

TRS ...

Cat. No.	Symbol	Um	Weight [kg/pc.]	Dim. L [mm]	Dim. M [mm]
786322	TRS M6	200 pcs.	0,011	25	6
786324	TRS M8	100 pcs.	0,013	30	8
786326	TRS M10	50 pcs.	0,022	40	10
786328	TRS M12	50 pcs.	0,043	50	12

CHAINS

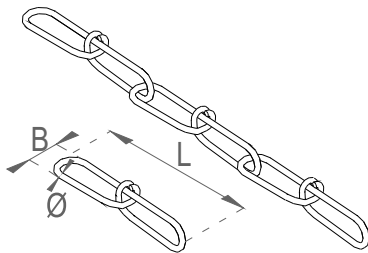

Application:
Fixing cable routes elements.

Material:
Galvanized steel (DIN 50961)

LNS ...

Cat. No.	Symbol	Um	Weight [kg/m]	Dim. B [mm]	Dim. L [mm]	φ [mm]	Max loading [kg]
790290	LNS1,4	60 mb	0,042	6,5	21	1,4	15
786330	LNS2	30 mb	0,080	9	28	2	40

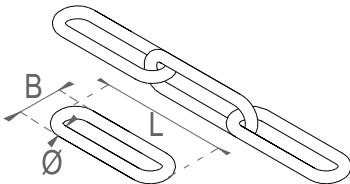

Application:
Fixing cable routes elements.

Material:
Galvanized steel (DIN 50961)

LNP ...

Cat. No.	Symbol	Um	Weight [kg/m]	Dim. B [mm]	Dim. L [mm]	φ [mm]	Max loading [kg]
790291	LNP2	100 mb	0,063	9	18	2	30
786331	LNP2,2	100 mb	0,064	10	29	2,2	20
790292	LNP3	100 mb	0,132	12,5	23	3	50
790293	LNP5	40 mb	0,456	19	31	5	195

METAL ANCHOR

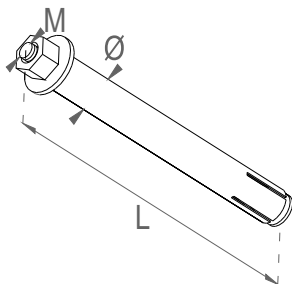

Application:
Fixing cable routes elements.

Material:
Galvanized steel (DIN 50961)

STRZ...

Cat. No.	Symbol	Um	Weight [kg/pc.]	Dim. L [mm]	Dim. M [mm]	φ[mm]
786332	STRZ M6/10x60	100 pcs.	0,025	60	6	10
786333	STRZ M6/10x100	100 pcs.	0,040	100	6	10
786334	STRZ M8/12x60	100 pcs.	0,040	60	8	12
786335	STRZ M8/12x80	100 pcs.	0,050	80	8	12
786336	STRZ M8/12x100	100 pcs.	0,065	100	8	12
786337	STRZ M8/12x120	100 pcs.	0,075	120	8	12
786591	STRZ M8/12x150	100 pcs.	0,080	150	8	12
786338	STRZ M10/16x80	100 pcs.	0,095	80	10	16
786339	STRZ M10/16x100	50 pcs.	0,115	100	10	16
786340	STRZ M10/16x120	50 pcs.	0,135	120	10	16
786341	STRZ M12/18x100	50 pcs.	0,155	100	12	18
786342	STRZ M12/18x120	50 pcs.	0,175	120	12	18

CLOSED HOOK BOLT

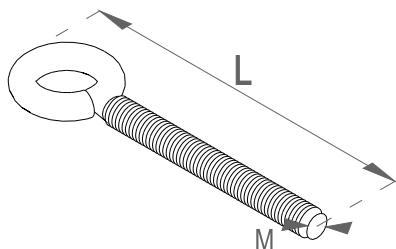

Application:
Fixing cable routes elements.

Material:
Galvanized steel (DIN 50961)

SHZ...

Cat. No.	Symbol	Um	Weight [kg/pc.]	Dim. L [mm]	Dim. M [mm]
786343	SHZ M6x80	100 pcs.	0,018	80	6
786344	SHZ M8x100	100 pcs.	0,044	100	8
786345	SHZ M10x120	50 pcs.	0,079	120	10

OPEN HOOK BOLT

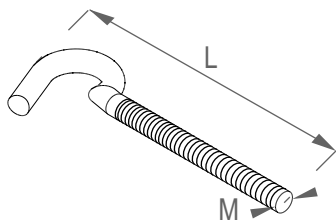

Application:
Fixing cable routes elements.

Material:
Galvanized steel (DIN 50961)

SHO...

Cat. No.	Symbol	Um	Weight [kg/pc.]	Dim. L [mm]	Dim. M [mm]
789683	SHO M6x80	100 pcs.	0,018	80	6
789684	SHO M8x100	100 pcs.	0,044	100	8
789685	SHO M10x120	50 pcs.	0,079	120	10



VII

HOOK-TYPES METAL ANCHOR

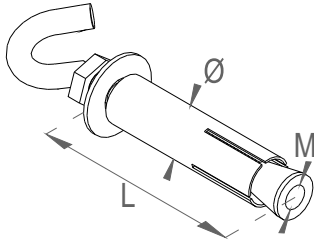

Application:
Fixing cable routes elements.

Material:
Galvanized steel (DIN 50961)

SHRO ...

Cat. No.	Symbol	Um	Weight [kg/pc.]	Dim. L [mm]	Dim. M [mm]	φ [mm]
786349	SHRO M6/10x80	50 pcs.	0,033	80	6	10
786350	SHRO M8/12x100	25 pcs.	0,060	100	8	12
786351	SHRO M10/14x120	25 pcs.	0,136	120	10	14

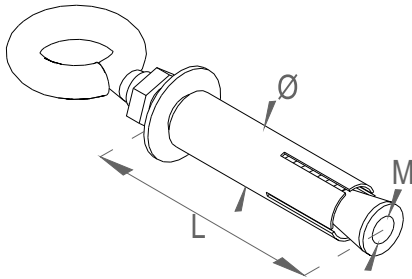

Application:
Fixing cable routes elements.

Material:
Galvanized steel (DIN 50961)

SHRZ ...

Cat. No.	Symbol	Um	Weight [kg/pc.]	Dim. L [mm]	Dim. D [mm]	φ [mm]
786352	SHRZ M6/10x80	50 pcs.	0,034	80	6	10
786353	SHRZ M8/12x100	25 pcs.	0,066	100	8	12
786354	SHRZ M10/14x120	25 pcs.	0,140	120	10	14

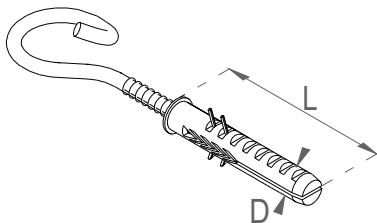

Application:
Fixing cable routes elements.

Material:
Galvanized steel (DIN 50961)

SHTR ...

Cat. No.	Symbol	Um	Weight [kg/pc.]	Dim. D [mm]	Dim. L [mm]
786346	SHTR 10x80	50 pcs.	0,020	10	80
786347	SHTR 12x100	50 pcs.	0,030	12	100
786348	SHTR 14x120	50 pcs.	0,040	14	120

SWING BOLT

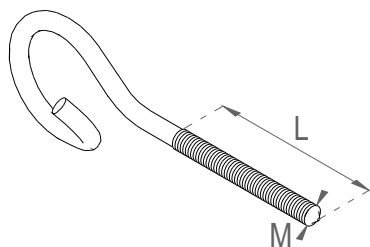

Application:
Fixing cable routes elements.

Material:
Galvanized steel (DIN 50961)

SHT...

Cat. No.	Symbol		Um	Weight [kg/pc.]	Dim. M [mm]	Dim. L [mm]
786359	SHT M6x80	50	pcs.	0,015	80	6
786360	SHT M8x100	50	pcs.	0,025	100	8
786361	SHT M10x120	50	pcs.	0,035	120	10

STEEL CORD

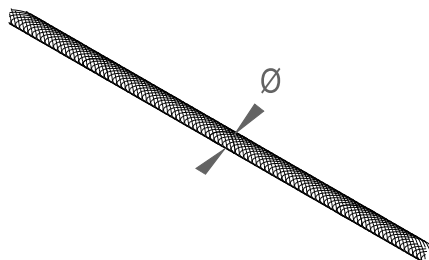

Application:
Fixing light cable routes.

Material:
Galvanized steel (DIN 50961)

LST...

Cat. No.	Symbol		Um	Weight [kg/m]	φ [mm]	Maks. obciążenie [kg/m]
786355	LST2	250	mb	0,020	2	59
786356	LST3	200	mb	0,031	3	132
786357	LST4	150	mb	0,060	4	235
786358	LST5	150	mb	0,088	5	368

CORD CLAMP



Application:
Fixing cord.

Material:
Galvanized steel (DIN 50961)

ZCL...

Cat. No.	Symbol		Um	Weight [kg/pc.]
786314	ZCL-3	100	pcs.	0,010
786315	ZCL-4	100	pcs.	0,013
786316	ZCL-5	100	pcs.	0,015



BOLT, NUT, WASHER (SET)

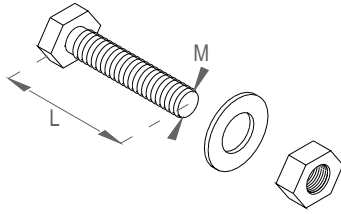

Application:
Connecting cable trays.

Material:
Galvanized steel (DIN 50961)

SNP ...

Cat. No.	Symbol		Um	Weight [kg/pc.]	Dim. L [mm]	Dim. M [mm]
786365	SNP M6x10	100	pcs.	0,008	10	6
786366	SNP M6x14	100	pcs.	0,008	14	6
786367	SNP M6x16	100	pcs.	0,009	16	6
786368	SNP M6x25	100	pcs.	0,010	25	6
786369	SNP M8x12	100	pcs.	0,016	12	8
786370	SNP M8x16	100	pcs.	0,018	16	8
786371	SNP M8x30	100	pcs.	0,022	30	8
786372	SNP M8x50	100	pcs.	0,028	50	8
786373	SNP M10x16	100	pcs.	0,034	16	10
786374	SNP M10x20	100	pcs.	0,036	20	10
786375	SNP M10x30	100	pcs.	0,042	30	10
786376	SNP M10x60	100	pcs.	0,057	60	10
786377	SNP M10x80	100	pcs.	0,069	80	10
786378	SNP M12x30	100	pcs.	0,084	30	12

BOLT, SQUARE NUT

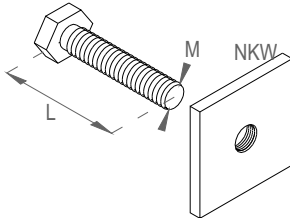

Application:
Connecting cable trays.

Material:
Galvanized steel (DIN 50961)

SNK ...

Cat. No.	Symbol		Um	Weight [kg/pc.]	Dim. L [mm]	Dim. M [mm]
786379	SNK M6x12	100	pcs.	0,019	12	6
786380	SNK M8x12	100	pcs.	0,023	12	8

SQUARE NUT

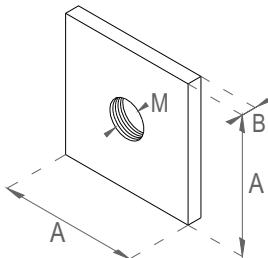

Application:
Quick fastening to KTM profile.

Material:
Galvanized steel (DIN 50961)

NKW ...

Cat. No.	Symbol		Um	Weight [kg/pc.]	Dim. A [mm]	Dim. B [mm]	Dim. M [mm]
786382	NKW M6	100	pcs.	0,019	25	4	6
786383	NKW M8	100	pcs.	0,023	25	4	8

THREADED ROD

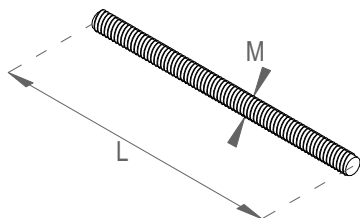

Application:
Fixing cable routes to ceiling.

Material:
Galvanized steel (DIN 50961)

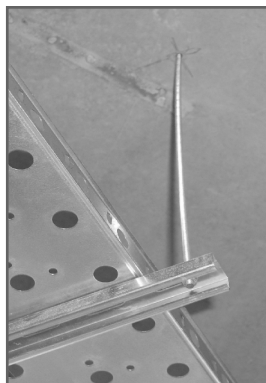

PGW M . . .

Cat. No.	Symbol		Um	Weight [kg/pc.]	Dim. L [mm]	Dim. M [mm]
786401	PGW M6 1000	100	pcs.	0,165	1000	6
786402	PGW M6 2000	50	pcs.	0,330	2000	6
789476	PGW M6 3000	50	pcs.	0,495	3000	6
786403	PGW M8 100	1	pcs.	0,031	100	8
786404	PGW M8 200	1	pcs.	0,061	200	8
786405	PGW M8 300	1	pcs.	0,092	300	8
786406	PGW M8 1000	50	pcs.	0,306	1000	8
786407	PGW M8 2000	50	pcs.	0,612	2000	8
789477	PGW M8 3000	50	pcs.	0,918	3000	8
786408	PGW M10 1000	25	pcs.	0,480	1000	10
786409	PGW M10 2000	25	pcs.	0,960	2000	10
789478	PGW M10 3000	25	pcs.	1,440	3000	10
786410	PGW M12 1000	25	pcs.	0,710	1000	12
786411	PGW M12 2000	25	pcs.	1,420	2000	12

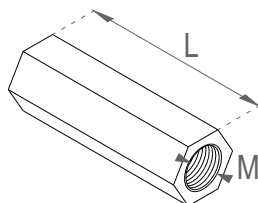

CONNECTING NUT

Application:
Connecting threaded rods.

Material:
Galvanized steel (DIN 50961)

NKL M . . .

Cat. No.	Symbol		Um	Weight [kg/pc.]	Dim. L [mm]	Dim. M [mm]
786303	NKL M6	100	pcs.	0,013	18	6
786304	NKL M8	100	pcs.	0,020	24	8
786305	NKL M10	50	pcs.	0,040	30	10
786306	NKL M12	50	pcs.	0,065	36	12

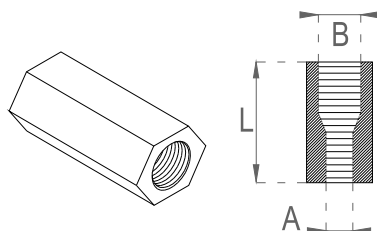

REDUCING NUT

Application:
Connecting threaded rods with various diameters.

Material:
Galvanized steel (DIN 50961)



VII

NRD M . . .

Cat. No.	Symbol		Um	Weight [kg/pc.]	Dim. A [mm]	Dim. B [mm]	Dim. L [mm]
786362	NRD 6/8	10	pcs.	0,021	6	8	18
786363	NRD 8/10	10	pcs.	0,040	8	10	24
786364	NRD 10/12	10	pcs.	0,065	10	12	30

THROUGH BOLT ANCHOR

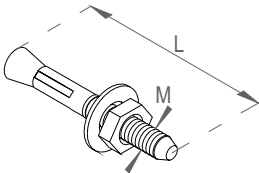

Application:
Fixing mounting elements to concrete.

Material:
Galvanized steel (DIN 50961)

PSR ...

Cat. No.	Symbol	Um	Weight [kg/pc.]	Dim. L [mm]	Dim. M [mm]
786611	PSR M6x40	200 pcs.	0,010	40	6
786612	PSR M6x65	200 pcs.	0,015	65	6
786613	PSR M6x100	200 pcs.	0,020	100	6
786614	PSR M8x50	200 pcs.	0,025	50	8
786615	PSR M8x75	100 pcs.	0,030	75	8
786616	PSR M8x95	100 pcs.	0,040	95	8
786617	PSR M8x115	100 pcs.	0,045	115	8
786618	PSR M8x150	100 pcs.	0,060	150	8
786619	PSR M10x65	100 pcs.	0,045	65	10
786620	PSR M10x90	100 pcs.	0,060	90	10
786621	PSR M10x120	50 pcs.	0,080	120	10
786622	PSR M10x150	50 pcs.	0,095	150	10
786623	PSR M12x70	50 pcs.	0,070	70	12
786624	PSR M12x110	50 pcs.	0,105	110	12
786625	PSR M12x140	50 pcs.	0,130	140	12
786626	PSR M12x180	50 pcs.	0,165	180	12
786627	PSR M12x220	50 pcs.	0,200	220	12

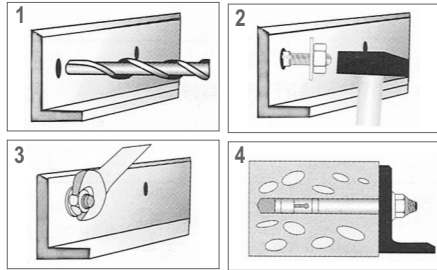

TKN CLAMP WITH HOLE

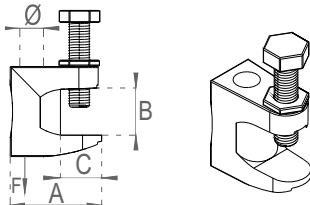

Application:
Fixing cable routes to I-beams.

Material:
Galvanized steel (DIN 50961)

TKN ...

Cat. No.	Symbol	Um	Weight [kg/pc.]	Dim. A [mm]	Dim. B [mm]	Dim. C [mm]	φ [mm]	Max loading F [kg]
789646	TKN9	1 pcs.	0,081	38	18	20	9	120
789647	TKN11	1 pcs.	0,141	45	20	23	11	120
791575	TKN13	1 pcs.	0,224	58	28	23	13	250

TKN CLAMP WITH THREAD

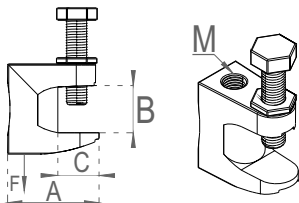

Application:
Fixing cable routes to I-beams.

Material:
Galvanized steel (DIN 50961)

TKN M. . .

Cat. No.	Symbol	Um	Weight [kg/pc.]	Dim. A [mm]	Dim. B [mm]	Dim. C [mm]	M [mm]	Max loading F [kg]
790957	TKN M6	1 pcs.	0,061	38	18	20	6	50
789310	TKN M8	1 pcs.	0,081	38	18	20	8	120
789311	TKN M10	1 pcs.	0,143	45	20	23	10	120
790956	TKN M12	1 pcs.	0,224	58	28	23	12	250

CHANNEL NUT

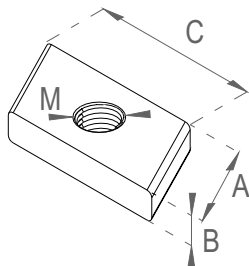

Material:
Galvanized steel (DIN 50961)

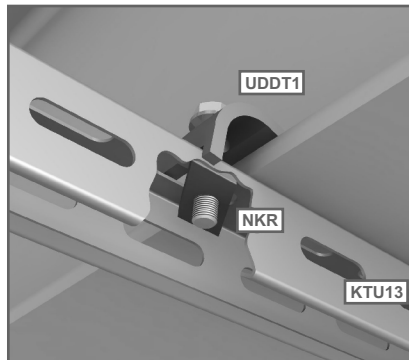

NKR ...

Cat. No.	Symbol	Um	Weight [kg/pc.]	Dim. A [mm]	Dim. B [mm]	Dim. C [mm]	Dim. M [mm]
789312	NKR6	1 pcs.	0,021	19	4	35	6
789313	NKR8	1 pcs.	0,027	19	5	35	8
789314	NKR10	1 pcs.	0,032	19	6	35	10

ZINC SPRAY



Application:
Supplementation of damaged zinc layer.

CS400

Cat. No.	Symbol	Um	Weight [kg]	Capacity [L]
789470	CS400	1 pcs.	0,50	0,40

PROTECTIVE PVC PROFILE

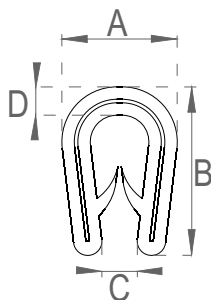

Application:
Protecting edges of cable routes elements.

Material:
PVC with steel core.



PO PCV

Cat. No.	Symbol	Um	Weight [kg/pc.]	Dim. A [mm]	Dim. B [mm]	Dim. C [mm]	Dim. D [mm]
789660	PO PCV	100 mb.	0,065	6,5	9,5	1-2	1,6

HOOK TO EYE TYPE BOLT

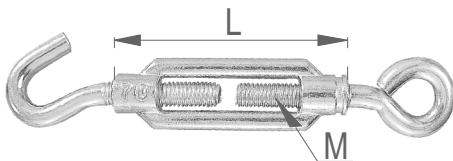

Application:
Fixing cable routes elements.

Material:
Galvanized steel (DIN 50961)

KHO ...						
Cat. No.	Symbol		Um	Weight [kg/pc.]	Dim. L [mm]	Dim. M [mm]
790580	KHO M6x90	50	pcs.	0,004	90	6
790581	KHO M8x110	30	pcs.	0,007	110	8
790582	KHO M10x130	20	pcs.	0,011	130	10
790583	KHO M12x140	10	pcs.	0,024	140	12

EYE TO EYE TYPE BOLT

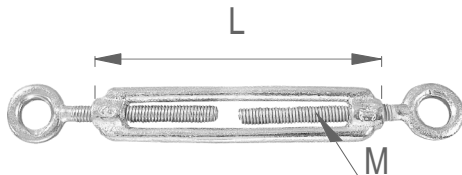

Application:
Fixing cable routes elements.

Material:
Galvanized steel (DIN 50961)

KOO ...						
Cat. No.	Symbol		Um	Weight [kg/pc.]	Dim. L [mm]	Dim. M [mm]
790584	KOO M6x90	50	pcs.	0,004	90	6
790585	KOO M8x110	30	pcs.	0,007	110	8
790586	KOO M10x130	20	pcs.	0,011	130	10
790587	KOO M12x140	10	pcs.	0,024	140	12

HOOK TO HOOK TYPE BOLT

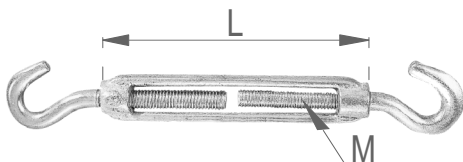

Application:
Fixing cable routes elements.

Material:
Galvanized steel (DIN 50961)

KHH ...						
Cat. No.	Symbol		Um	Weight [kg/pc.]	Dim. L [mm]	Dim. M [mm]
790588	KHH M6x90	50	pcs.	0,004	90	6
790589	KHH M8x110	30	pcs.	0,007	110	8
790590	KHH M10x130	20	pcs.	0,011	130	10
790591	KHH M12x140	10	pcs.	0,024	140	12

HAMMER-DRIVE ANCHOR

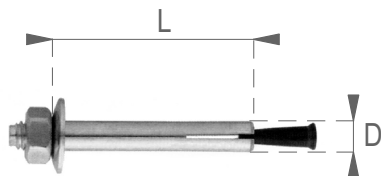

Application:
Fixing cable routes elements.

Material:
Galvanized steel (DIN 50961).

SRW . . .

Cat. No.	Symbol	Um	Weight [kg/pc.]	Dim. D [mm]	Dim. L [mm]
791778	SRW M6x30	100 pcs.	0,021	6	35

WEDGE-TYPE, HAMMER-DRIVE METAL ANCHOR

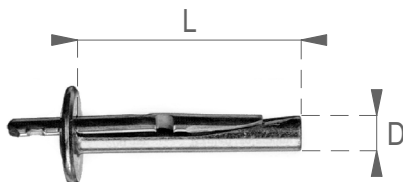

Application:
Fixing cable routes elements.

Material:
Galvanized steel (DIN 50961).

KRW . . .

Cat. No.	Symbol	Um	Weight [kg/pc.]	Dim. D [mm]	Dim. L [mm]
791779	KRW 6x35	100 pcs.	0,021	6	35

HAMMER-DRIVE PIN

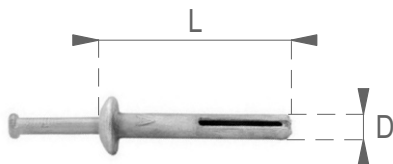

Application:
Fixing cable routes elements.

Material:
ZnAl alloy.

KMW . . .

Cat. No.	Symbol	Um	Weight [kg/pc.]	Dim. D [mm]	Dim. L [mm]
791780	KMW 6x30	100 pcs.	0,021	6	30
791781	KMW 6x40	100 pcs.	0,027	6	40
791782	KMW 6x50	100 pcs.	0,032	6	50



VII

NOTES
